

Synflex SS Hose End Fittings 390A/390L (90A,90L) Series

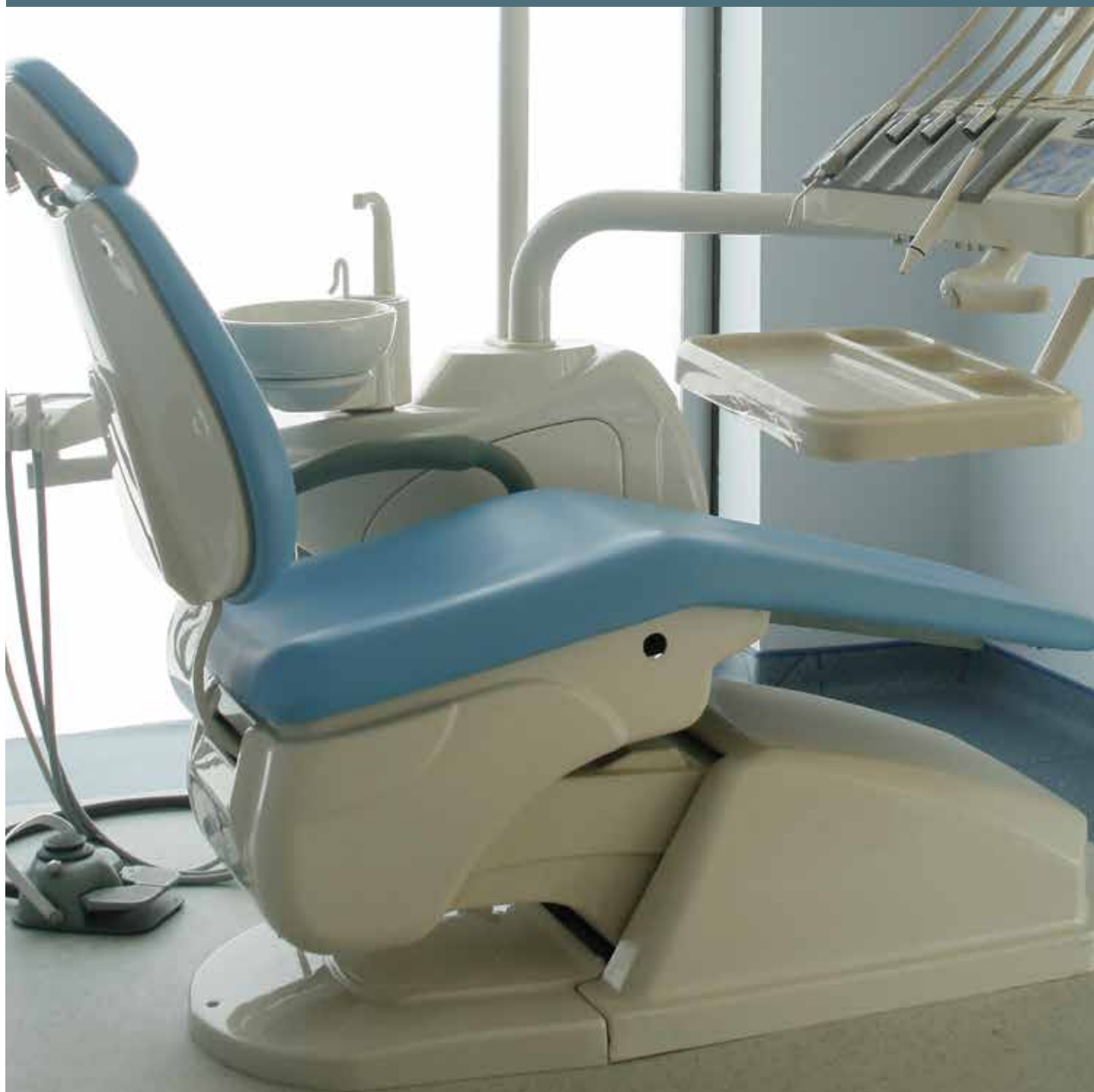

Synflex Permanent Swage Fittings

Female JIC/SAE 37° Swivel Stainless Steel
AISI 316 (90A)

90A fittings for use with hose: 3630 (-03 to -12), 3R30, 3130, 3580, 37AL, 3740 (-12 to -16), 3800 (-03 to -08), 3440 (-04 to -08), 3840, 34PW (-04 to -08), 31B0, 30CT (-03 to -08)

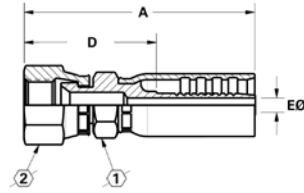

# Part Number	Terminal End	Thread	Hose Size		A		D Cut Off Factor		E Ø		1	2
			DN	Dash Size	mm	in	mm	in	mm	in		
90A03-045400-0	-04	7/16-20	5	-03	54,6	2.15	33,3	1.31	2,8	0.11	9/16	5/8
90A04-045400-0	-04	7/16-20	6	-04	64,2	2.53	36,6	1.44	4,0	0.16	5/8	5/8
90A06-065500-0	-06	9/16-18	10	-06	71,6	2.82	39,6	1.56	7,1	0.28	3/4	3/4
90A08-085400-0	-08	3/4-16	12	-08	80,0	3.15	41,4	1.63	9,9	0.39	7/8	15/16
90A08-105400-0‡	-10	7/8-14	12	-08	80,0	3.15	41,4	1.63	9,9	0.39	7/8	1-1/16
90A12-125500-0‡	-12	1-1/16-12	19	-12	87,2	3.43	44,5	1.75	15,9	0.63	1-1/8	1-1/4
90A16-165500-0‡	-16	1-5/16-12	25	-16	103,0	4.06	50,8	2.00	20,7	0.81	1-3/8	1-1/2

Stand Pipe Stainless Steel (90A)

90A fittings for use with hose: 3630 (-03 to -12), 3R30, 3130, 3580, 37AL, 3740 (-12 to -16), 3800 (-03 to -08), 3440 (-04 to -08), 3840, 34PW (-04 to -08), 31B0, 30CT (-03 to -08)

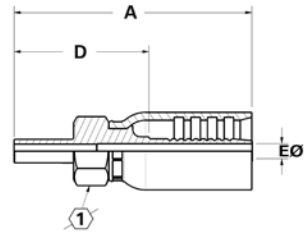

# Part Number	Terminal End	Thread	Hose Size		A		D Cut Off Factor		E Ø		1	2
			DN	Dash Size	mm	in	mm	in	mm	in		
90A04-04J000-0	-04	--	6	-04	63,4	2.50	36,6	1.44	4,0	0.16	5/8	--
90A06-06J000-0	-06	--	10	-06	69,9	2.75	38,1	1.50	7,1	0.28	3/4	--
90A08-08J000-0	-08	--	12	-08	81,2	3.20	42,9	1.69	9,9	0.39	7/8	--

Synflex Permanent Swage Fittings

Male Pipe Stainless Steel (90L)

90L fittings for use with hose: 3630 (-16), 3R80 (-03 to -16), 3E80 (-03 to -16), 3440 (-12 to -16), 34PW (-12 to -16), 34BA (-06)

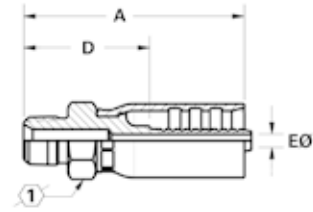

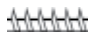

# Part Number	Terminal End	 Thread	 Hose Size		A		D Cut Off Factor		E Ø			
			Dash Size	DN	Dash Size	mm	in	mm	in	mm	in	in
90L04-041000-0	-04	1/4 - 18	6	-04	58,7	2.31	31,8	1.25	4,1	0.16	11/16	--
90L06-061000-0	-06	3/8 - 18	10	-06	66,0	2.60	33,3	1.31	7,1	0.28	3/4	--
90L08-081000-0	-08	3/8 - 18	12	-08	77,0	3.03	38,1	1.50	10,2	0.40	15/16	--
90L12-121000-0	-12	3/4 - 14	19	-12	81,5	3.21	41,4	1.63	16,0	0.63	1-1/8	--
90L16-161000-0	-16	1-11 1/2	25	-16	100,6	3.96	47,8	1.88	20,6	0.81	1-3/8	--

Female JIC/SAE 37° Swivel Stainless Steel AISI 316 (90L)

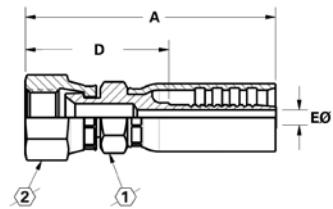
90L fittings for use with hose: 3630 (-16), 3R80 (-03 to -16), 3E80 (-03 to -16), 3440 (-12 to -16), 34PW (-12 to -16), 34BA (-06)

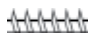

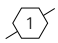
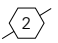

# Part Number	Terminal End	 Thread	 Hose Size		A		D Cut Off Factor		E Ø			
			Dash Size	DN	Dash Size	mm	in	mm	in	mm	in	in
90L03-045400-0	-04	7/16-20	5	-03	54,6	2.15	35,1	1.38	2,8	0.11	9/16	5/8
90L04-045400-0	-04	7/16-20	6	-04	64,2	2.53	36,6	1.44	4,0	0.16	5/8	5/8
90L06-065500-0	-06	9/16-18	10	-06	71,6	2.82	39,6	1.56	7,1	0.28	3/4	3/4
90L06-085400-0	-08	3/4-16	10	-06	71,3	2.81	39,6	1.56	7,1	0.28	3/4	15/16
90L08-085400-0	-08	3/4-16	12	-08	80,0	3.15	41,4	1.63	9,9	0.39	7/8	15/16
90L08-105400-0	-10	7/8-14	12	-08	80,0	3.15	41,4	1.63	9,9	0.39	7/8	1-1/16
90L12-125500-0	-12	1-1/16-12	19	-12	87,2	3.43	44,5	1.75	15,9	0.63	1-1/8	1-1/4
90L16-165500-0	-16	1-5/16-12	25	-16	103,0	4.06	49,3	1.94	20,6	0.81	1-3/8	1-1/2

Stand Pipe Stainless Steel (90L)

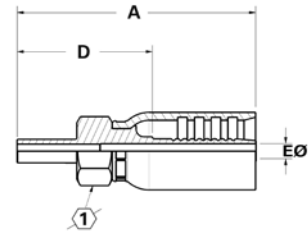
90L fittings for use with hose: 3630 (-16), 3R80 (-03 to -16), 3E80 (-03 to -16), 3440 (-12 to -16), 34PW (-12 to -16), 34BA (-06)

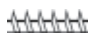

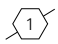
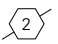
# Part Number	Terminal End	 Thread	 Hose Size		A		D Cut Off Factor		E Ø			
			Dash Size	DN	Dash Size	mm	in	mm	in	mm	in	in
90L04-04J000-0	-04	--	6	-04	63,4	2.50	36,6	1.44	4,0	0.16	5/8	--
90L06-06J000-0	-06	--	10	-06	69,9	2.75	38,1	1.50	7,1	0.28	3/4	--
90L08-08J000-0	-08	--	12	-08	81,2	3.20	42,9	1.69	9,9	0.39	7/8	--