

Synflex Hose End Fittings 3903 (903) Series

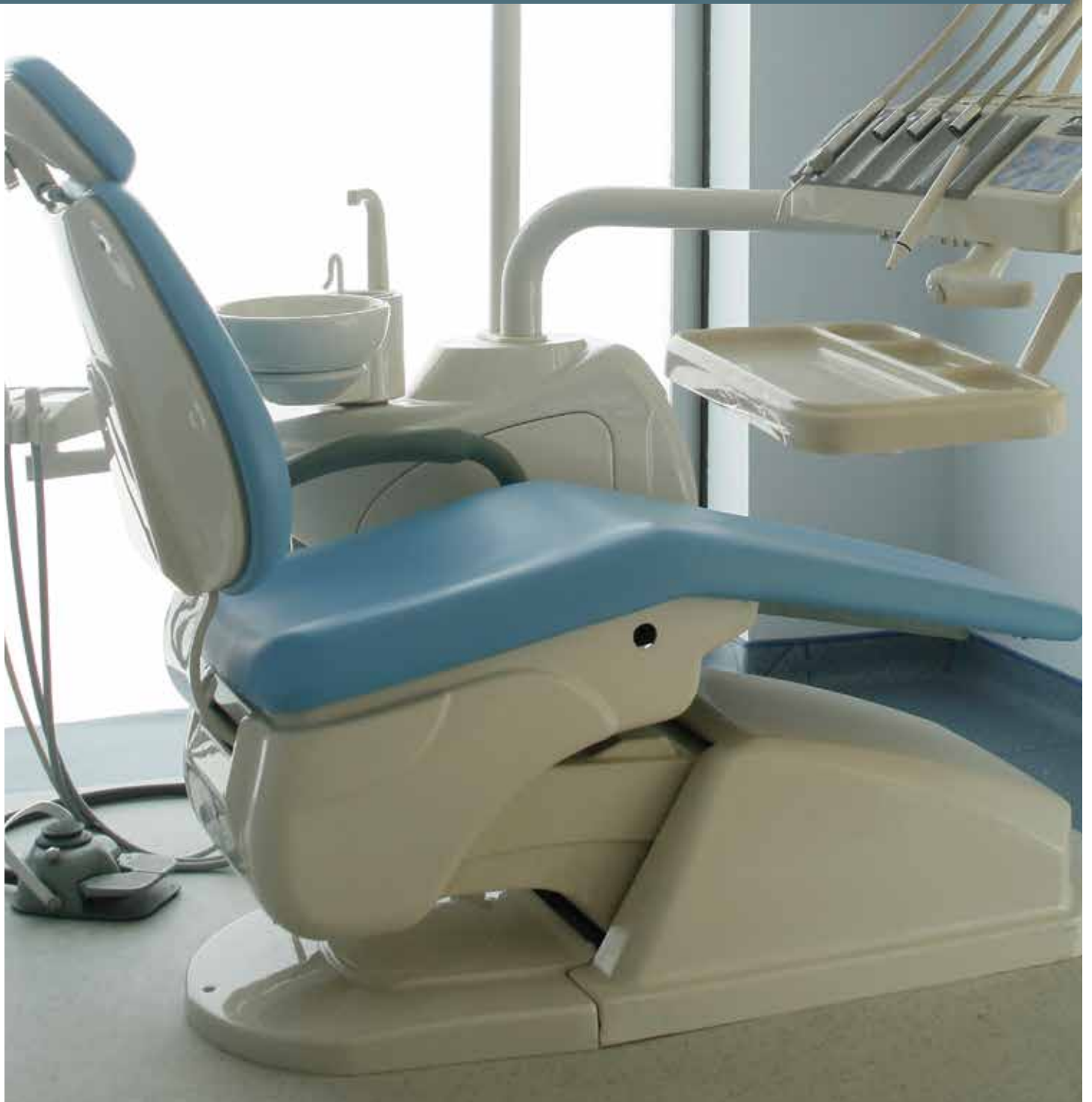

Synflex Permanent Swage Fittings

Male Pipe (903)

903 fittings for use with hose: 3630 (-03 to -12), 3R30, 3130, 37AL, 3740 (-12 to -16), 3800 (-03 to -08), 3580, 3440 (-04 to -08), 30CT (-04 to -08)

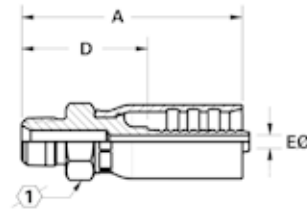

# Part Number	Terminal End	Thread	Hose Size		A		D Cut Off Factor		E Ø		1	2
			DN	Dash Size	mm	in	mm	in	mm	in		
90302-021000-0	-02	1/8-27	3	-02	33,0	1.30	19,1	0.75	1,8	0.07	1/2	--
90302-041000-0	-04	1/4-18	3	-02	37,6	1.48	23,8	0.94	1,8	0.07	5/8	--
90303-021000-0	-02	1/8-27	5	-03	47,5	1.87	27,0	1.06	2,8	0.11	9/16	--
90303-041000-0	-04	1/4-18	5	-03	52,3	2.06	31,8	1.25	2,8	0.11	11/16	--
90303-061000-0‡	-06	3/8-18	5	-03	54,6	2.15	35,1	1.38	2,8	0.11	3/4	--
90304-021000-0	-02	1/8-27	6	-04	53,8	2.12	25,4	1.00	4,1	0.16	5/8	--
90304-041000-0	-04	1/4-18	6	-04	58,7	2.31	30,2	1.19	4,1	0.16	11/16	--
90304-061000-0	-06	3/8-18	6	-04	61,0	2.40	33,3	1.31	4,1	0.16	3/4	--
90305-041000-0	-04	1/4-18	8	-05	58,7	2.31	30,2	1.19	5,6	0.22	11/16	--
90305-061000-0	-06	3/8-18	8	-05	61,0	2.40	31,8	1.25	5,6	0.22	3/4	--
90306-041000-0	-04	1/4-18	10	-06	65,8	2.59	33,3	1.31	7,1	0.28	3/4	--
90306-061000-0	-06	3/8-18	10	-06	65,8	2.59	33,3	1.31	7,1	0.28	3/4	--
90306-081000-0	-08	1/2-14	10	-06	72,1	2.84	36,6	1.44	7,1	0.28	15/16	--
90308-061000-0	-06	3/8-18	12	-08	70,6	2.78	33,3	1.31	10,2	0.40	7/8	--
90308-081000-0	-08	1/2-14	12	-08	77,0	3.03	38,1	1.50	10,2	0.40	15/16	--
90312-121000-0	-12	3/4-14	19	-12	81,5	3.21	41,4	1.63	16,0	0.63	1-1/8	--
90316-161000-0	-16	1-11-1/2	25	-16	100,6	3.96	47,8	1.88	20,6	0.81	1-3/8	--

Female Pipe (903)

903 fittings for use with hose: 3630 (-03 to -12), 3R30, 3130, 37AL, 3740 (-12 to -16), 3800 (-03 to -08), 3580, 3440 (-04 to -08), 30CT (-04 to -08)

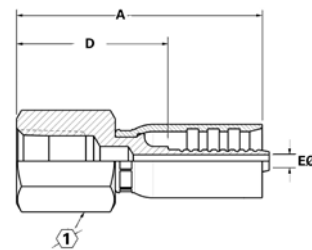

# Part Number	Terminal End	Thread	Hose Size		A		D Cut Off Factor		E Ø		1	2
			DN	Dash Size	mm	in	mm	in	mm	in		
90304-042000-0	-04	1/4-18	6	-04	59,4	2.34	31,8	1.25	4,0	0.16	3/4	--
90304-062000-0‡	-06	3/8-18	6	-04	61,8	2.43	33,3	1.31	4,0	0.16	7/8	--
90306-062000-0‡	-06	3/8-18	10	-06	66,6	2.62	35,1	1.38	7,1	0.28	7/8	--
90308-082000-0‡	-08	1/2-14	12	-08	75,3	2.96	38,1	1.50	9,9	0.39	1-1/16	--



‡Run-to-order product. Contact your Eaton customer service representative for details.

Synflex Permanent Swage Fittings

Male Pipe Swivel (903)

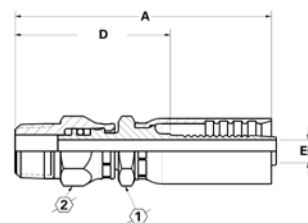
903 fittings for use with hose: 3630 (-03 to -12), 3R30, 3130, 37AL, 3740 (-12 to -16), 3800 (-03 to -08), 3580, 3440 (-04 to -08), 30CT (-04 to -08)

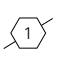
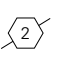

# Part Number	Terminal End	 Thread	 Hose Size		A		D Cut Off Factor		E Ø		 1	 2
	Dash Size		DN	Dash Size	mm	in	mm	in	mm	in	in	in
90302-021400-0	-02	1/8-27	3	-02	48,3	1.90	49,3	1.94	2,0	0.08	1/2	1/2
90303-041400-0	-04	1/4-18	5	-03	67,1	2.64	46,0	1.81	2,8	0.11	5/8	11/16
90304-041400-0	-04	1/4-18	6	-04	73,2	2.88	46,0	1.81	4,1	0.16	5/8	11/16
90305-041400-0	-04	1/4-18	8	-05	73,2	2.88	44,5	1.75	5,6	0.22	5/8	11/16
90306-061400-0	-06	3/8-18	10	-06	80,5	3.17	49,3	1.94	7,1	0.28	3/4	3/4
90306-081400-0‡	-08	1/2-14	10	-06	85,3	3.36	54,1	2.13	7,1	0.28	3/4	7/8
90308-081400-0	-08	1/2-14	12	-08	91,7	3.61	54,1	2.13	9,9	0.39	7/8	15/16
90312-121400-0	-12	3/4-14	19	-12	98,0	3.86	55,6	2.19	15,2	0.60	1-1/8	1-1/8
90316-161400-0‡	-16	1-11-1/2	25	-16	118,6	4.67	66,8	2.63	20,6	0.81	1-3/8	1-1/2

Synflex Permanent Swage Fittings

Female JIC/SAE 37° Swivel (903)

903 fittings for use with hose: 3630 (-03 to -12), 3R30, 3130, 37AL, 3740 (-12 to -16), 3800 (-03 to -08), 3580, 3440 (-04 to -08), 30CT (-04 to -08)

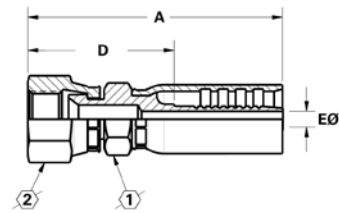

# Part Number	Terminal End	Thread	Hose Size		A		D Cut Off Factor		E Ø		1	2
			DN	Dash Size	mm	in	mm	in	mm	in	in	in
90302-035500-0	-03	3/8 - 24	3	-02	40,9	1.61	26,9	1.06	2,0	0.08	1/2	9/16
90302-045400-0	-04	7/16 - 20	3	-02	43,2	1.70	26,9	1.06	2,0	0.08	1/2	5/8
90302-055400-0‡	-05	1/2 - 20	3	-02	42,7	1.68	26,9	1.06	2,0	0.08	1/2	3/4
90303-035400-0‡	-03	3/8 - 24	5	-03	54,6	2.15	33,3	1.31	2,8	0.11	9/16	9/16
90303-045400-0	-04	7/16 - 20	5	-03	54,6	2.15	35,1	1.38	2,8	0.11	9/16	5/8
90303-055400-0	-05	1/2 - 20	5	-03	54,6	2.15	35,1	1.38	2,8	0.11	9/16	3/4
90304-045400-0	-04	7/16 - 20	6	-04	64,3	2.53	36,6	1.44	4,1	0.16	5/8	5/8
90304-055400-0	-05	1/2 - 20	6	-04	64,3	2.53	36,6	1.44	4,1	0.16	5/8	3/4
90304-055403-0	-05	1/2 - 20	6	-04	64,3	2.53	36,6	1.44	4,1	0.16	5/8	5/8
90304-065500-0	-06	9/16 - 18	6	-04	64,5	2.54	36,6	1.44	4,1	0.16	5/8	3/4
90305-045400-0‡	-04	7/16 - 20	8	-05	64,3	2.53	36,6	1.44	5,6	0.22	5/8	5/8
90305-055400-0	-05	1/2 - 20	8	-05	64,3	2.53	33,3	1.31	5,6	0.22	5/8	3/4
90305-065500-0	-06	9/16 - 18	8	-05	64,5	2.54	36,6	1.44	5,6	0.22	5/8	3/4
90306-045400-0‡	-04	7/16 - 20	10	-06	68,1	2.68	36,6	1.44	7,1	0.28	13/16	5/8
90306-055400-0‡	-05	1/2 - 20	10	-06	68,1	2.68	36,6	1.44	5,8	0.23	3/4	3/4
90306-065500-0	-06	9/16 - 18	10	-06	71,6	2.82	39,6	1.56	7,1	0.28	3/4	3/4
90306-085400-0	-08	3/4 - 16	10	-06	71,4	2.81	39,6	1.56	7,1	0.28	3/4	15/16
90306-105400-0‡	-10	7/8 - 14	10	-06	75,2	2.96	42,9	1.69	7,1	0.28	7/8	1-1/16
90308-085400-0	-08	3/4 - 16	12	-08	80,0	3.15	41,4	1.63	9,9	0.39	7/8	15/16
90308-105400-0	-10	7/8 - 14	12	-08	80,0	3.15	41,4	1.63	9,9	0.39	7/8	1-1/16
90308-125500-0	-12	1-1/16 - 12	12	-08	82,6	3.25	44,5	1.75	9,9	0.39	1-1/8	1-1/4
90312-105400-0‡	-10	7/8 - 14	19	-12	87,1	3.43	41,4	1.63	12,2	0.48	1-1/8	1-1/16
90312-125500-0	-12	1-1/16 - 12	19	-12	87,1	3.43	44,5	1.75	16,0	0.63	1-1/8	1-1/4
90312-145500-0‡	-14	1-3/16 - 12	19	-12	88,6	3.49	42,9	1.69	16,0	0.63	1-3/8	1-1/2
90312-165500-0‡	-16	1-5/16 - 12	19	-12	88,6	3.49	42,9	1.69	16,0	0.63	1-3/8	1-1/2
90316-165500-0	-16	1-5/16 - 12	25	-16	105,7	4.16	42,9	1.69	20,6	0.81	1-3/8	1-1/2

Torque Values

Hose Size	in lbs	
	Min	Max
-04	50	150
-05	70	200
-06	90	300
-08	150	500
-10	220	700
-12	300	1,000
-16	450	1,400

The maximum torques listed are based upon strength rather than sealing properties. Use of any torque within the minimum/maximum range will prevent damage or leakage.

Synflex Permanent Swage Fittings

Female JIC/SAE 37° Swivel 45° Elbow (903)

903 fittings for use with hose: 3630 (-03 to -12), 3R30, 3130, 37AL, 3740 (-12 to -16), 3800 (-03 to -08), 3580, 3440 (-04 to -08), 30CT (-04 to -08)

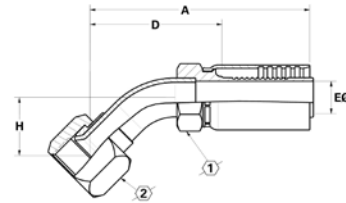

# Part Number	Terminal End	Thread	Hose Size		A		D Cut Off Factor		E Ø		H		1	2
			DN	Dash Size	mm	in	mm	in	mm	in	mm	in		
90303-045540-0#	-04	7/16-20	5	-03	58,4	2.30	38,1	1.50	2,8	0.11	11,9	0.47	9/16	9/16
90304-045540-0#	-04	7/16-20	6	-04	64,8	2.55	38,1	1.50	4,1	0.16	11,9	0.47	5/8	9/16
90304-055540-0#	-05	1/2-20	6	-04	67,1	2.64	39,6	1.56	4,1	0.16	13,5	0.53	5/8	5/8
90304-065540-0#	-06	9/16-18	6	-04	69,3	2.73	41,4	1.63	4,1	0.16	15,0	0.59	5/8	11/16
90305-065540-0	-06	9/16-18	8	-05	69,3	2.73	41,4	1.63	5,6	0.22	15,0	0.59	5/8	11/16
90306-065540-0	-06	9/16-18	10	-06	74,2	2.92	42,9	1.69	7,1	0.28	15,0	0.59	3/4	11/16
90306-085540-0#	-08	3/4-16	10	-06	78,7	3.10	47,8	1.88	7,1	0.28	18,0	0.71	3/4	7/8
90308-085540-0	-08	3/4-16	12	-08	83,3	3.28	46,0	1.81	9,9	0.39	18,0	0.71	7/8	7/8
90308-105540-0#	-10	7/8-14	12	-08	87,9	3.46	49,3	1.94	9,9	0.39	21,3	0.84	7/8	1
90312-125540-0#	-12	1-1/16-12	19	-12	108,2	4.26	65,3	2.57	16,0	0.63	28,4	1.12	1-1/8	1-1/4
90316-165540-0#	-16	1-5/15-12	25	-16	125,7	4.95	73,2	2.88	20,6	0.81	29,2	1.15	1-3/8	1-1/2

Female JIC/SAE 37° Swivel 90° Elbow (903)

903 fittings for use with hose: 3630 (-03 to -12), 3R30, 3130, 37AL, 3740 (-12 to -16), 3800 (-03 to -08), 3580, 3440 (-04 to -08), 30CT (-04 to -08)

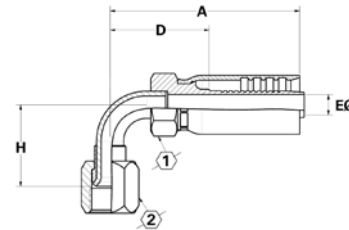

# Part Number	Terminal End	Thread	Hose Size		A		D Cut Off Factor		E Ø		H		1	2
			DN	Dash Size	mm	in	mm	in	mm	in	mm	in		
90302-0355S0-0#	-03	3/8-24	3	-02	37,7	1.48	23,9	0.94	2,0	0.08	19,1	0.75	1/2	7/16
90302-0455S0-0#	-04	7/16-20	3	-02	42,4	1.67	28,7	1.13	2,0	0.08	22,2	0.88	1/2	9/16
90303-0455S0-0	-04	7/16-20	5	-03	52,3	2.06	31,8	1.25	2,8	0.11	22,2	0.88	9/16	9/16
90304-0455S0-0	-04	7/16-20	6	-04	58,6	2.31	31,8	1.25	4,0	0.16	22,2	0.88	5/8	9/16
90304-0555S0-0	-05	1/2-20	6	-04	60,2	2.37	49,3	1.94	4,0	0.16	25,4	1.00	5/8	5/8
90304-0655S0-0	-06	9/16-18	6	-04	61,8	2.43	35,1	1.38	4,0	0.16	28,6	1.13	5/8	11/16
90305-0555S0-0#	-05	1/2-20	8	-05	60,2	2.37	31,8	1.25	5,6	0.22	25,4	1.00	5/8	5/8
90305-0655S0-0	-06	9/16-18	8	-05	61,7	2.43	49,3	1.94	5,6	0.22	28,6	1.13	5/8	11/16
90306-0455S0-0#	-04	7/16-20	10	-06	63,5	2.50	31,8	1.25	4,0	0.16	22,2	0.88	3/4	9/16
90306-0655S0-0	-06	9/16-18	10	-06	66,5	2.62	35,1	1.38	7,1	0.28	28,6	1.13	3/4	11/16
90306-0855S0-0	-08	3/4-16	10	-06	69,9	2.75	38,1	1.50	7,1	0.28	34,9	1.38	3/4	7/8
90308-0855S0-0	-08	3/4-16	12	-08	74,5	2.93	36,6	1.44	9,9	0.39	34,9	1.38	7/8	7/8
90308-1055S0-0	-10	7/8-14	12	-08	77,6	3.06	39,6	1.56	9,9	0.39	41,3	1.63	7/8	1
90312-1255S0-0#	-12	1-1/16-12	19	-12	98,3	3.87	55,6	2.19	15,9	0.63	58,7	2.31	1-1/8	1-1/4
90316-1655S0-0#	-16	1-5/15-12	25	-16	118,9	4.68	66,8	2.63	20,6	0.81	63,5	2.50	1-3/8	1-1/2

Synflex Permanent Swage Fittings

Female JIC/SAE 37° Swivel 90° Long Drop Elbow (903)

903 fittings for use with hose: 3630 (-03 to -12), 3R30, 3130, 37AL, 3740 (-12 to -16), 3800 (-03 to -08), 3580, 3440 (-04 to -08), 30CT (-04 to -08)

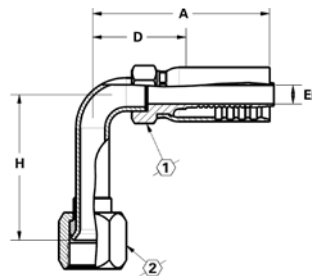

# Part Number	Terminal End	Thread	Hose Size		A		D Cut Off Factor		E Ø		H		1	2
			DN	Dash Size	mm	in	mm	in	mm	in	mm	in	in	in
90303-0455L0-0#	-04	7/16-20	5	-03	52,3	2.06	31,8	1.25	2,8	0.11	45,7	1.80	9/16	9/16
90304-0455L0-0	-04	7/16-20	6	-04	58,6	2.31	31,8	1.25	4,0	0.16	45,7	1.80	5/8	9/16
90304-0555L0-0#	-05	1/2-20	6	-04	60,2	2.37	49,3	1.94	4,0	0.16	45,0	1.77	5/8	5/8
90304-0655L0-0#	-06	9/16-18	6	-04	62,4	2.46	35,1	1.38	4,0	0.16	55,4	2.18	5/8	11/16
90305-0655L0-0	-06	9/16-18	8	-05	61,8	2.43	49,3	1.94	5,6	0.22	55,4	2.18	5/8	11/16
90306-0655L0-0	-06	9/16-18	10	-06	66,5	2.62	35,1	1.38	7,1	0.28	55,4	2.18	3/4	11/16
90306-0855L0-0	-08	3/4-16	10	-06	69,9	2.75	38,1	1.50	7,1	0.28	61,7	2.43	3/4	7/8
90308-0855L0-0	-08	3/4-16	12	-08	74,5	2.93	36,6	1.44	9,9	0.39	61,7	2.43	7/8	7/8
90308-1055L0-0	-10	7/8-14	12	-08	77,6	3.06	39,6	1.56	9,9	0.39	65,3	2.57	7/8	1
90312-1255L0-0#	-12	1-1/16-12	19	-12	98,3	3.87	55,6	2.19	15,9	0.63	94,7	3.73	1-1/8	1-1/4
90316-1655L0-0#	-16	1-5/16-12	25	-16	119,0	4.69	66,8	2.63	20,6	0.81	110,0	4.33	1-3/8	1-1/2

Male JIC/SAE 37° (903)

903 fittings for use with hose: 3630 (-03 to -12), 3R30, 3130, 37AL, 3740 (-12 to -16), 3800 (-03 to -08), 3580, 3440 (-04 to -08), 30CT (-04 to -08)

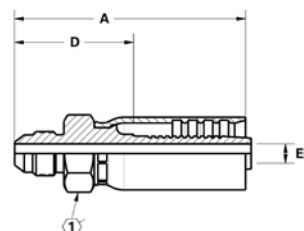

# Part Number	Terminal End	Thread	Hose Size		A		D Cut Off Factor		E Ø		1	2
			DN	Dash Size	mm	in	mm	in	mm	in	in	in
90303-035000-0#	-03	3/8-24	5	-03	50,1	1.97	30,2	1.19	2,8	0.11	9/16	--
90303-045000-0	-04	7/16-20	5	-03	51,9	2.05	31,8	1.25	2,8	0.11	9/16	--
90304-045000-0	-04	7/16-20	6	-04	58,3	2.30	31,8	1.25	4,0	0.16	5/8	--
90304-055000-0#	-05	1/2-20	6	-04	58,3	2.30	31,8	1.25	4,0	0.16	5/8	--
90304-065000-0	-06	9/16-18	6	-04	60,8	2.40	33,3	1.31	4,0	0.16	3/4	--
90305-055000-0	-05	1/2-20	8	-05	58,3	2.30	30,2	1.19	5,6	0.22	5/8	--
90305-065000-0	-06	9/16-18	8	-05	58,4	2.30	30,2	1.19	5,6	0.22	11/16	--
90306-065000-0	-06	9/16-18	10	-06	65,6	2.58	33,3	1.31	7,1	0.28	3/4	--
90306-085000-0	-08	3/4-16	10	-06	68,2	2.68	36,6	1.44	7,1	0.28	13/16	--
90308-085000-0	-08	3/4-16	12	-08	72,9	2.87	35,1	1.38	9,9	0.39	7/8	--
90308-105000-0	-10	7/8-14	12	-08	77,3	3.04	39,6	1.56	9,9	0.39	15/16	--
90308-125000-0#	-12	1-1/16-12	12	-08	79,8	3.14	41,4	1.63	9,9	0.39	1-1/8	--
90312-125000-0#	-12	1-1/16-12	19	-12	84,5	3.33	41,4	1.63	15,9	0.61	1-1/8	--
90316-165000-0#	-16	1-5/16-12	25	-16	100,0	3.94	47,8	1.88	20,6	0.81	1-3/8	--

Synflex Permanent Swage Fittings

Female SAE 45° Swivel (903)

903 fittings for use with hose: 3630 (-03 to -12), 3R30, 3130, 37AL, 3740 (-12 to -16), 3800 (-03 to -08), 3580, 3440 (-04 to -08), 30CT (-04 to -08)

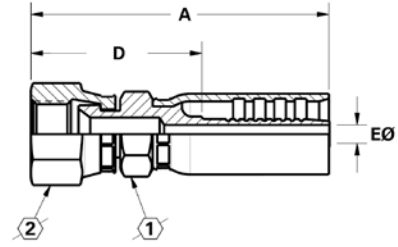

# Part Number	Terminal End	Thread	Hose Size		A		D Cut Off Factor		E Ø		1	2
			DN	Dash Size	mm	in	mm	in	mm	in	in	in
90303-045400-0	-04	7/16-20	5	-03	54,6	2.15	35,1	1.38	2,8	0.11	9/16	5/8
90303-055400-0	-05	1/2-20	5	-03	54,6	2.15	35,1	1.38	2,8	0.11	9/16	3/4
90304-045400-0	-04	7/16-20	6	-04	64,2	2.53	36,6	1.44	4,0	0.16	5/8	5/8
90304-055400-0	-05	1/2-20	6	-04	64,2	2.53	36,6	1.44	4,0	0.16	5/8	3/4
90304-06A000-0‡	-06	5/8-18	6	-04	64,2	2.53	36,6	1.44	4,0	0.16	5/8	13/16
90305-055400-0	-05	1/2-20	8	-05	64,2	2.53	35,1	1.38	5,6	0.22	5/8	3/4
90305-06A000-0‡	-06	5/8-18	8	-05	64,2	2.53	35,1	1.38	5,6	0.22	5/8	13/16
90306-06A000-0	-06	5/8-18	10	-06	71,3	2.81	39,6	1.56	7,1	0.28	3/4	13/16
90306-085400-0	-08	3/4-16	10	-06	71,3	2.81	39,6	1.56	7,1	0.28	3/4	15/16
90308-085400-0	-08	3/4-16	12	-08	80,0	3.15	41,4	1.63	9,9	0.39	7/8	15/16
90308-105400-0	-10	7/8-14	12	-08	80,0	3.15	41,4	1.63	9,9	0.39	7/8	1-1/16
90312-12A000-0‡	-12	1-1/16-14	19	-12	87,2	3.43	44,5	1.75	15,9	0.63	1-1/8	1-1/4
90316-16A000-0‡	-16	1-3/8-12	25	-16	107,9	4.25	55,6	2.19	20,6	0.81	1-1/2	1-5/8

Male Boss O-Ring (903)

903 fittings for use with hose: 3630 (-03 to -12), 3R30, 3130, 37AL, 3740 (-12 to -16), 3800 (-03 to -08), 3580, 3440 (-04 to -08), 30CT (-04 to -08)

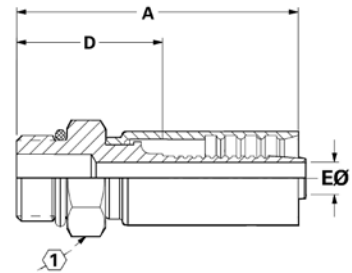

DO NOT swage with o-ring installed

# Part Number	Terminal End	Thread	Hose Size		A		D Cut Off Factor		E Ø		1	2
			DN	Dash Size	mm	in	mm	in	mm	in	in	in
90303-04D000-0	-04	7/16-20	5	-03	48,0	1.89	26,9	1.06	2,8	.11	9/16	--
90304-04D000-0	-04	7/16-20	6	-04	53,5	2.11	26,2	1.03	4,0	0.16	5/8	--
90304-05D000-0	-05	1/2-20	6	-04	53,5	2.11	26,2	1.03	4,0	0.16	5/8	--
90304-06D000-0	-06	9/16-18	6	-04	54,3	2.14	26,9	1.06	4,0	0.16	11/16	--
90305-05D000-0‡	-05	1/2-20	8	-05	53,5	2.11	22,4	0.88	5,6	0.22	11/16	--
90306-06D000-0‡	-06	9/16-18	10	-06	61,4	2.42	29,5	1.16	7,1	0.28	3/4	--
90306-08D000-0‡	-08	3/4-16	10	-06	62,6	2.47	30,2	1.19	7,1	0.28	7/8	--
90308-08D000-0‡	-08	3/4-16	12	-08	68,9	2.71	27,7	1.09	9,9	0.39	15/16	--
90308-10D000-0‡	-10	7/8-14	16	-10	70,5	2.78	32,5	1.28	9,9	0.39	1-1/16	--

Synflex Permanent Swage Fittings

Female ORS Swivel (903)

903 fittings for use with hose: 3630 (-03 to -12), 3R30, 3130, 37AL, 3740 (-12 to -16), 3800 (-03 to -08), 3580, 3440 (-04 to -08), 30CT (-04 to -08)

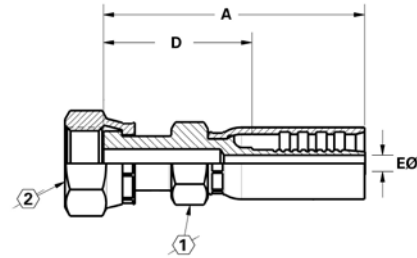

# Part Number	Terminal End Dash Size	Thread	Hose Size		A		D Cut Off Factor		E Ø		1	2
			DN	Dash Size	mm	in	mm	in	mm	in		
90302-044000-0#	-04	9/16-18	3	-02	45,2	1.78	31,0	1.22	2,0	0.08	5/8	11/16
90304-044000-0	-04	9/16-18	6	-04	66,0	2.60	38,6	1.52	4,0	0.16	5/8	11/16
90304-064000-0#	-06	11/16-16	6	-04	63,6	2.50	36,1	1.42	4,0	0.16	5/8	7/8
90305-044000-0#	-04	9/16-18	8	-05	66,0	2.60	37,5	1.48	5,6	0.22	5/8	11/16
90305-064000-0	-06	11/16-16	8	-05	67,8	2.67	39,2	1.55	9,5	0.38	5/8	13/16
90306-064000-0	-06	11/16-16	10	-06	68,3	2.69	36,6	1.44	6,9	0.27	3/4	7/8
90306-084000-0	-08	13/16-16	10	-06	77,2	3.04	45,4	1.79	6,9	0.27	3/4	15/16
90308-084000-0	-08	13/16-16	12	-08	77,7	3.06	39,8	1.57	9,7	0.38	15/16	1-1/16
90308-104000-0#	-10	1-14	12	-08	84,5	3.33	46,5	1.83	9,9	0.39	7/8	1-1/8
90312-124000-0	-12	1-3/16-12	19	-12	92,5	3.64	49,7	1.96	15,5	0.61	1-1/8	1-3/8
90316-164000-0#	-16	1-7/16-12	25	-16	110,7	4.36	55,1	2.17	20,6	0.81	1-3/8	1-5/8

Female ORS Swivel 90° Elbow Short Drop (903)

903 fittings for use with hose: 3630 (-03 to -12), 3R30, 3130, 37AL, 3740 (-12 to -16), 3800 (-03 to -08), 3580, 3440 (-04 to -08), 30CT (-04 to -08)

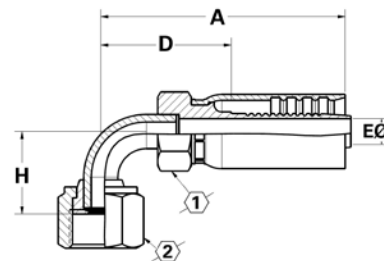

# Part Number	Terminal End Dash Size	Thread	Hose Size		A		D Cut Off Factor		E Ø		H		1	2
			DN	Dash Size	mm	in	mm	in	mm	in	mm	in		
90302-0440S0-0#	-04	9/16-18	3	-02	42,6	1.68	28,7	1.13	2,0	0.08	19,8	0.78	1/2	11/16
90304-0440S0-0	-04	9/16-18	6	-04	58,8	2.31	31,8	1.25	4,0	0.16	19,8	0.78	5/8	11/16
90305-0440S0-0#	-04	9/16-18	8	-05	58,8	2.31	30,2	1.19	5,6	0.22	19,8	0.78	5/8	11/16
90305-0640S0-0	-06	11/16-16	8	-05	63,3	2.49	49,3	1.94	7,1	0.28	22,9	0.90	3/4	13/16
90306-0640S0-0	-06	11/16-16	10	-06	68,1	2.68	36,6	1.44	7,1	0.28	22,9	0.90	3/4	13/16
90308-0840S0-0#	-08	13/16-16	12	-08	75,7	2.98	38,1	1.50	9,9	0.39	29,2	1.15	7/8	15/16
90312-1240S0-0#	-12	1-3/16-12	19	-12	94,2	3.71	50,8	2.00	15,9	0.63	47,8	1.88	1-1/8	1-3/8

#Run-to-order product. Contact your Eaton customer service representative for details.

Synflex Permanent Swage Fittings

Female SAE 30° Inverted Flare NPSM (903)

903 fittings for use with hose: 3630 (-03 to -12), 3R30, 3130, 37AL, 3740 (-12 to -16), 3800 (-03 to -08), 3580, 3440 (-04 to -08), 30CT (-04 to -08)

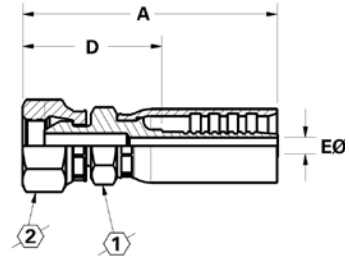

# Part Number	Terminal End	Thread	Hose Size		A		D Cut Off Factor		E Ø		1	2
			DN	Dash Size	mm	in	mm	in	mm	in	in	in
90302-042400-0	-04	1/4-18	3	-02	41,9	1.65	26,9	1.06	2,0	0.08	1/2	11/16
90303-042400-0	-04	1/4-18	5	-03	54,2	2.13	33,3	1.31	2,8	0.11	5/8	3/4
90304-042400-0	-04	1/4-18	6	-04	60,6	2.38	33,3	1.31	4,0	0.16	5/8	3/4
90304-062400-0‡	-06	3/8-18	6	-04	62,6	2.46	35,1	1.38	4,0	0.16	3/4	7/8
90305-042400-0	-04	1/4-18	8	-05	64,5	2.54	36,6	1.44	5,6	0.22	3/4	3/4
90306-042400-0‡	-04	1/4-18	10	-06	67,7	2.67	36,6	1.44	5,5	0.22	3/4	3/4
90306-062400-0	-06	3/8-18	10	-06	67,4	2.65	30,2	1.19	7,1	0.28	3/4	7/8
90308-082400-0	-08	1/2-14	12	-08	75,9	2.99	38,1	1.50	9,9	0.39	1	1
90312-122400-0‡	-12	3/4-14	19	-12	87,2	3.43	44,5	1.75	15,9	0.63	1-1/8	1-1/4
90316-162400-0‡	-16	1-11-1/2	25	-16	103,1	4.06	47,8	1.88	20,6	0.81	1-3/8	1-1/2

Torque Values

Hose Size	in lbs	
	Min	Max
-04	50	150
-05	70	200
-06	90	300
-08	150	500
-10	220	700
-12	300	1,000
-16	450	1,400

The maximum torques listed are based upon strength rather than sealing properties. Use of any torque within the minimum/maximum range will prevent damage or leakage.