

CM-Series Hydraulic Couplings

Interchange Data:

- Mold Coolant Interchange
Foster Series-FJT, Hansen Flo-Temp, Tomco MC-Series
Parker Moldmate, DME Jiffy-Tite

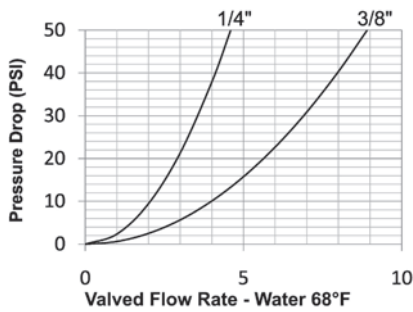
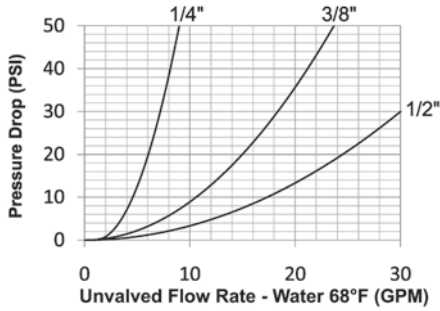

Materials:

- Machined components are manufactured using solid steel or brass bar stock.
- Stainless steel balls, retaining rings, and springs maximize corrosion resistance and extend service life.
- Steel componentry is plated using ROHS Compliant Trivalent Chrome.

Seal Components:

- Silicon gaskets and valve O-rings are standard, providing a temperature range of -90°F to +400°F (-68°C to +205°C).

CM Series Profiles

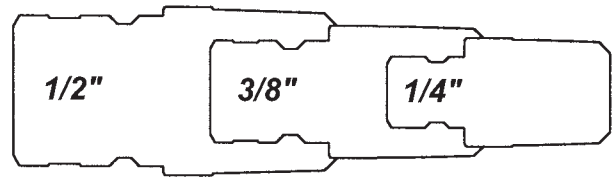

Rated Pressure Chart:

Body Size	CM-Series Industrial Mold Interchange (Connected)															
	Unvalved Coupler/Brass Plug				Unvalved Coupler/Steel Plug				Valved Coupler/Brass Plug				Valved Coupler/Steel Plug			
	Max. Working		Burst		Max. Working		Burst		Max. Working		Burst		Max. Working		Burst	
	PSI	Bar	PSI	Bar	PSI	Bar	PSI	Bar	PSI	Bar	PSI	Bar	PSI	Bar	PSI	Bar
1/4"	300	20	10,000	700	500	35	10,700	750	300	20	6,000	400	300	20	6,100	400
3/8"	300	20	14,500	1,000	500	35	14,200	1,000	300	20	6,700	450	300	20	6,100	400
1/2"	300	20	4,900	340	-	-	-	-	-	-	-	-	-	-	-	-

Technical Specifications:

Body Size	Interchange Standards				Functional Parameters					
	U.S. Military	U.S. Government	International Standards	ANSI/NFPA Standards	Locking Ball Quantity	Air Inclusion	Fluid Loss	Vacuum Inch HG	Flow $\Delta P = 7$ PSI	
1/4"	-	-	-	-	6	N/A	N/A	N/R	3 GPM	
3/8"	-	-	-	-	8	N/A	N/A	N/R	9 GPM	
1/2"	-	-	-	-	8	N/A	N/A	N/R	15 GPM	

CM-Series Hydraulic Couplings

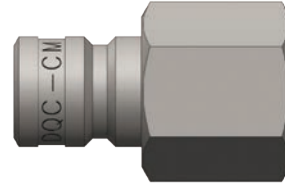
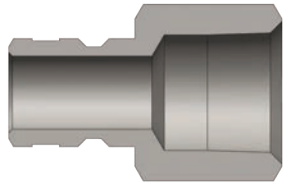

Body Size	CM-Series Industrial Mold Interchange Nipple (Female Threads)											
	Part Detail				Length		Maximum OD		Hex Inch	Weight Lb	Package Qty	
	Part Number	Threads	Material		Inch	mm	Inch	mm			Bag	Box
1/4"	CM2F1	1/8" - 27 NPTF	steel		0.90	22.9	0.58	14.7	1/2"	0.02	10	100
1/4"	CM2F1-B	1/8" - 27 NPTF	brass		0.90	22.9	0.58	14.7	1/2"	0.02	10	100
1/4"	CM2F2	1/4" - 18 NPTF	steel		1.12	28.4	0.72	18.3	5/8"	0.04	10	100
1/4"	CM2F2-B	1/4" - 18 NPTF	brass		1.12	28.4	0.72	18.3	5/8"	0.05	10	100
1/4"	CM2F3	3/8" - 18 NPTF	steel		1.21	30.7	0.87	22.1	3/4"	0.08	10	100
1/4"	CM2F3-B	3/8" - 18 NPTF	brass		1.21	30.7	0.87	22.1	3/4"	0.08	10	100
3/8"	CM3F2	1/4" - 18 NPTF	steel		1.34	34.0	0.72	18.3	5/8"	0.05	10	50
3/8"	CM3F2-B	1/4" - 18 NPTF	brass		1.34	34.0	0.72	18.3	5/8"	0.05	10	50
3/8"	CM3F3	3/8" - 18 NPTF	steel		1.34	34.0	0.87	22.1	3/4"	0.06	10	50
3/8"	CM3F3-B	3/8" - 18 NPTF	brass		1.34	34.0	0.87	22.1	3/4"	0.07	10	50
1/2"	CM4F4-B	1/2" - 14 NPTF	brass		1.69	42.9	1.16	29.5	1"	0.09	5	30
1/2"	CM4F6-B	3/4" - 14 NPTF	brass		1.69	42.9	1.37	34.8	1-3/16"	0.10	5	30

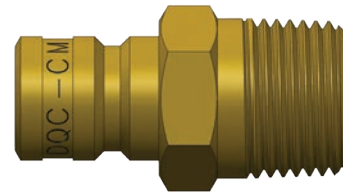
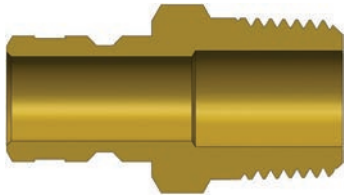

Body Size	CM-Series Industrial Mold Interchange Nipple (Male Threads)											
	Part Detail				Length		Maximum OD		Hex Inch	Weight Lb	Package Qty	
	Part Number	Threads	Material		Inch	mm	Inch	mm			Bag	Box
1/4"	CM2M1-B	1/8" - 27 NPTF	brass		1.00	25.4	0.65	16.5	9/16"	0.02	10	100
1/4"	CM2M2-B	1/4" - 18 NPTF	brass		1.15	29.2	0.65	16.5	9/16"	0.03	10	100
1/4"	CM2M3-B	3/8" - 18 NPTF	brass		1.21	30.7	0.79	20.1	11/16"	0.05	10	100
3/8"	CM3M2-B	1/4" - 18 NPTF	brass		1.37	34.8	0.65	16.5	9/16"	0.04	10	50
3/8"	CM3M3-B	3/8" - 18 NPTF	brass		1.43	36.3	0.79	20.1	11/16"	0.00	10	50
3/8"	CM3M4-B	1/2" - 14 NPTF	brass		1.58	40.1	1.01	25.7	7/8"	0.07	10	50
1/2"	CM4M4-B	1/2" - 14 NPTF	brass		1.69	42.9	1.01	25.7	7/8"	0.10	5	30
1/2"	CM4M6-B	3/4" - 14 NPTF	brass		1.79	45.5	1.23	31.2	1-1/16"	0.11	5	30

CM-Series Hydraulic Couplings



Body Size	CM-Series Industrial Mold Interchange Extension Nipple (Male Threads)											
	Part Detail				Length		Maximum OD		Hex Inch	Weight Lb	Package Qty	
	Part Number	Threads	Material		Inch	mm	Inch	mm			Bag	Box
1/4"	CM2M1-B-L2.5	1/8" - 27 NPTF	brass		2.50	63.5	0.51	13.0	7/16"	0.06	10	50
1/4"	CM2M1-B-L4	1/8" - 27 NPTF	brass		4.00	101.6	0.51	13.0	7/16"	0.10	10	50
1/4"	CM2M1-B-L5.5	1/8" - 27 NPTF	brass		5.50	139.7	0.51	13.0	7/16"	0.13	10	50
1/4"	CM2M2-B-L2.5	1/4" - 18 NPTF	brass		2.50	63.5	0.65	16.5	9/16"	0.09	10	50
1/4"	CM2M2-B-L4	1/4" - 18 NPTF	brass		4.00	101.6	0.65	16.5	9/16"	0.15	10	50
1/4"	CM2M2-B-L5.5	1/4" - 18 NPTF	brass		5.50	139.7	0.65	16.5	9/16"	0.22	10	50
1/4"	CM2M2-B-L7	1/4" - 18 NPTF	brass		7.00	177.8	0.65	16.5	9/16"	0.27	10	50
3/8"	CM3M1-B-L2.5	1/8" - 27 NPTF	brass		2.50	63.5	0.65	16.5	9/16"	0.07	5	25
3/8"	CM3M1-B-L4	1/8" - 27 NPTF	brass		4.00	101.6	0.65	16.5	9/16"	0.11	5	25
3/8"	CM3M1-B-L5.5	1/8" - 27 NPTF	brass		5.50	139.7	0.65	16.5	9/16"	0.15	5	25
3/8"	CM3M1-B-L7	1/8" - 27 NPTF	brass		7.00	177.8	0.65	16.5	9/16"	0.18	5	25
3/8"	CM3M2-B-L2.5	1/4" - 18 NPTF	brass		2.50	63.5	0.65	16.5	9/16"	0.09	5	25
3/8"	CM3M2-B-L4	1/4" - 18 NPTF	brass		4.00	101.6	0.65	16.5	9/16"	0.15	5	25
3/8"	CM3M2-B-L5.5	1/4" - 18 NPTF	brass		5.50	139.7	0.65	16.5	9/16"	0.21	5	25
3/8"	CM3M2-B-L7	1/4" - 18 NPTF	brass		7.00	177.8	0.65	16.5	9/16"	0.27	5	25
3/8"	CM3M2-B-L8.5	1/4" - 18 NPTF	brass		8.50	215.9	0.65	16.5	9/16"	0.33	5	25
3/8"	CM3M2-B-L11.5	1/4" - 18 NPTF	brass		11.50	292.1	0.65	16.5	9/16"	0.45	5	25

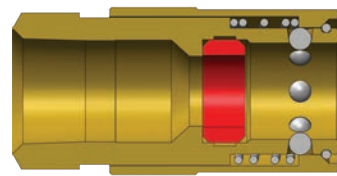

Body Size	CM-Series Industrial Mold Interchange Unvalved Coupler (Female Threads)											
	Part Detail				Length		Maximum OD		Hex Inch	Weight Lb	Package Qty	
	Part Number	Threads	Material		Inch	mm	Inch	mm			Bag	Box
1/4"	2CMF1-B-E	1/8" - 27 NPTF	brass		1.35	34.3	0.69	17.5	9/16"	0.07	10	100
1/4"	2CMF2-B-E	1/4" - 18 NPTF	brass		1.35	34.3	0.79	20.1	11/16"	0.08	10	100
3/8"	3CMF2-B-E	1/4" - 18 NPTF	brass		1.84	46.7	0.95	24.1	3/4"	0.21	10	50
3/8"	3CMF3-B-E	3/8" - 18 NPTF	brass		1.84	46.7	1.01	25.7	7/8"	0.23	10	50
1/2"	4CMF4-B-E	1/2" - 14 NPTF	brass		2.02	51.3	1.24	31.5	1-1/8"	0.34	5	30

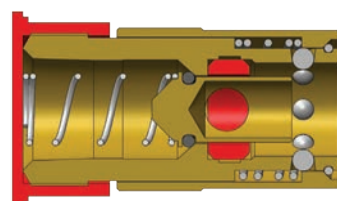

Body Size	CM-Series Industrial Mold Interchange Valved Coupler (Female Threads)											
	Part Detail				Length		Maximum OD		Hex Inch	Weight Lb	Package Qty	
	Part Number	Threads	Material		Inch	mm	Inch	mm			Bag	Box
1/4"	2CMF1-B	1/8" - 27 NPTF	brass		1.35	34.3	0.69	17.5	9/16"	0.07	10	100
3/8"	3CMF2-B	1/4" - 18 NPTF	brass		1.84	46.7	0.95	24.1	3/4"	0.21	10	50

CM-Series Hydraulic Couplings

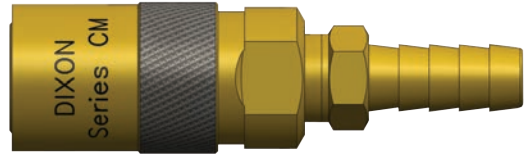
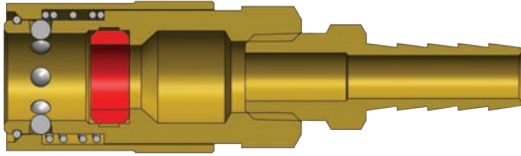

Body Size	CM-Series Industrial Mold Interchange Unvalved Coupler (Hose Barb)											
	Part Detail			Length		Maximum OD		Hex Inch	Weight Lb	Package Qty		
	Part Number	Hose ID	Material	Inch	mm	Inch	mm			Bag	Box	
1/4"	2CMS2-B-E	1/4"	brass	2.11	53.6	0.69	17.5	-	0.10	10	100	
1/4"	2CMS2.5-B-E	5/16"	brass	2.10	53.3	0.69	17.5	-	0.09	10	100	
1/4"	2CMS3-B-E	3/8"	brass	2.10	53.3	0.69	17.5	-	0.11	10	100	
3/8"	3CMS3-B-E	3/8"	brass	2.55	64.8	0.95	24.1	-	0.24	10	50	
3/8"	3CMS4-B-E	1/2"	brass	2.55	64.8	0.95	24.1	-	0.25	10	50	
1/2"	4CMS4-B-E	1/2"	brass	2.98	75.7	1.18	30.0	-	0.46	5	30	
1/2"	4CMS6-B-E	3/4"	brass	2.98	75.7	1.18	30.0	-	0.48	5	30	

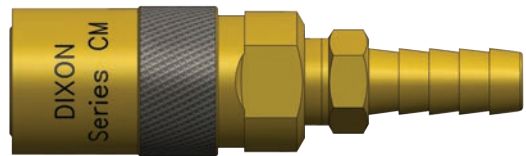
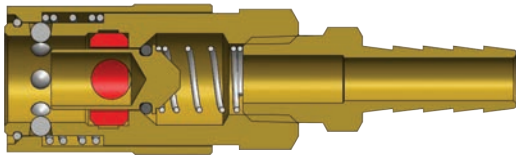

Body Size	CM-Series Industrial Mold Interchange Valved Coupler (Hose Barb)											
	Part Detail			Length		Maximum OD		Hex Inch	Weight Lb	Package Qty		
	Part Number	Hose ID	Material	Inch	mm	Inch	mm			Bag	Box	
1/4"	2CMS2-B	1/4"	brass	2.66	67.6	0.69	17.5	-	0.10	10	100	
1/4"	2CMS2.5-B	5/16"	brass	2.66	67.6	0.69	17.5	-	0.10	10	100	
1/4"	2CMS3-B	3/8"	brass	2.66	67.6	0.69	17.5	-	0.10	10	100	
3/8"	3CMS3-B	3/8"	brass	3.30	83.8	0.95	24.1	-	0.27	10	50	
3/8"	3CMS4-B	1/2"	brass	3.28	83.3	0.95	24.1	-	0.28	10	50	

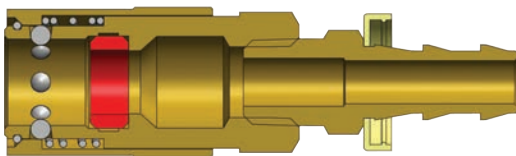

Body Size	CM-Series Industrial Mold Interchange Unvalved Coupler (Push-Loc Barb)											
	Part Detail			Length		Maximum OD		Hex Inch	Weight Lb	Package Qty		
	Part Number	Hose ID	Material	Inch	mm	Inch	mm			Bag	Box	
1/4"	2CMB2-B-E	1/4"	brass	2.08	52.8	0.69	17.5	-	0.10	10	100	
1/4"	2CMB3-B-E	3/8"	brass	2.08	52.8	0.69	17.5	-	0.11	10	100	
3/8"	3CMB3-B-E	3/8"	brass	2.53	64.3	0.95	24.1	-	0.26	10	50	
3/8"	3CMB4-B-E	1/2"	brass	2.69	68.3	0.95	24.1	-	0.25	10	50	
1/2"	4CMB4-B-E	1/2"	brass	3.12	79.2	1.18	30.0	-	0.50	5	30	
1/2"	4CMB6-B-E	3/4"	brass	3.12	79.2	1.18	30.0	-	0.51	5	30	

CM-Series Hydraulic Couplings

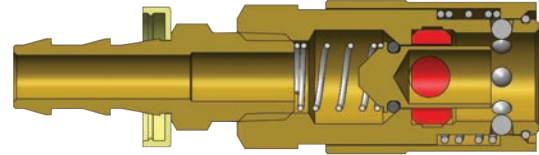
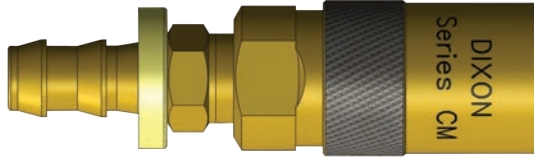

Body Size	CM-Series Industrial Mold Interchange Valved Coupler (Push-Loc Barb)											
	Part Detail			Length		Maximum OD		Hex Inch	Weight Lb	Package Qty		
	Part Number	Hose ID	Material	Inch	mm	Inch	mm			Bag	Box	
1/4"	2CMB2-B	1/4"	brass	2.64	67.1	0.69	17.5	-	0.10	10	100	
1/4"	2CMB3-B	3/8"	brass	2.67	67.8	0.69	17.5	-	0.13	10	100	
3/8"	3CMB3-B	3/8"	brass	3.28	83.3	0.95	24.1	-	0.29	10	50	
3/8"	3CMB4-B	1/2"	brass	3.44	87.4	0.95	24.1	-	0.30	10	50	

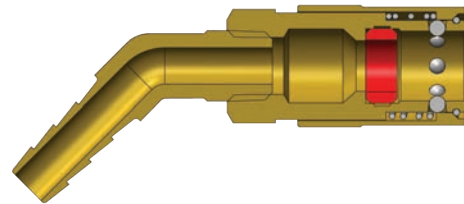
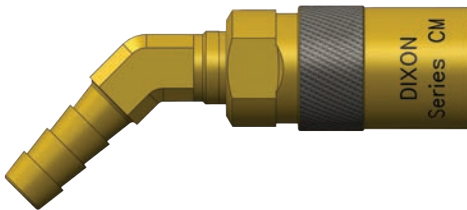

Body Size	CM-Series Industrial Mold Interchange Unvalved Coupler (45° Hose Barb)											
	Part Detail			Length		Maximum OD		Hex Inch	Weight Lb	Package Qty		
	Part Number	Hose ID	Material	Inch	mm	Inch	mm			Bag	Box	
1/4"	2CM4S2-B-E	1/4"	brass	2.87	72.9	0.69	17.5	-	0.13	10	100	
1/4"	2CM4S2.5-B-E	5/16"	brass	2.89	73.4	0.69	17.5	-	0.13	10	100	
1/4"	2CM4S3-B-E	3/8"	brass	2.91	73.9	0.69	17.5	-	0.13	10	100	
3/8"	3CM4S3-B-E	3/8"	brass	3.83	97.3	0.95	24.1	-	0.36	10	50	
3/8"	3CM4S4-B-E	1/2"	brass	3.86	98.0	0.95	24.1	-	0.36	10	50	
1/2"	4CM4S4-B-E	1/2"	brass	4.18	106.2	1.18	30.0	-	0.74	5	30	
1/2"	4CM4S6-B-E	3/4"	brass	4.56	115.8	1.18	30.0	-	0.76	5	30	

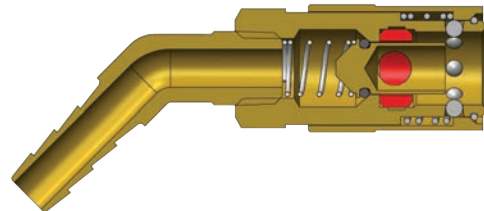
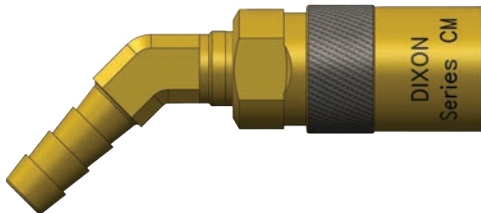

Body Size	CM-Series Industrial Mold Interchange Valved Coupler (45° Hose Barb)											
	Part Detail			Length		Maximum OD		Hex Inch	Weight Lb	Package Qty		
	Part Number	Hose ID	Material	Inch	mm	Inch	mm			Bag	Box	
1/4"	2CM4S2-B	1/4"	brass	2.87	72.9	0.69	17.5	-	0.13	10	100	
1/4"	2CM4S2.5-B	5/16"	brass	2.89	73.4	0.69	17.5	-	0.13	10	100	
1/4"	2CM4S3-B	3/8"	brass	2.91	73.9	0.69	17.5	-	0.14	10	100	
3/8"	3CM4S3-B	3/8"	brass	3.83	97.3	0.95	24.1	-	0.36	10	50	
3/8"	3CM4S4-B	1/2"	brass	3.86	98.0	0.95	24.1	-	0.36	10	50	

CM-Series Hydraulic Couplings

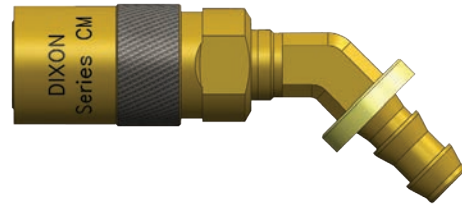
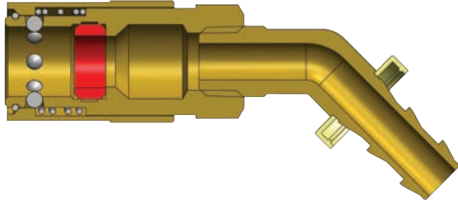

Body Size	CM-Series Industrial Mold Interchange Unvalved Coupler (45° Push-Loc Barb)										
	Part Detail			Length		Maximum OD		Hex Inch	Weight Lb	Package Qty	
	Part Number	Hose ID	Material	Inch	mm	Inch	mm			Bag	Box
1/4"	2CM4B2-B-E	1/4"	brass	2.86	72.6	0.69	17.5	-	0.13	10	100
1/4"	2CM4B3-B-E	3/8"	brass	2.92	74.2	0.69	17.5	-	0.15	10	100
3/8"	3CM4B3-B-E	3/8"	brass	3.82	97.0	0.95	24.1	-	0.34	10	50
3/8"	3CM4B4-B-E	1/2"	brass	3.98	101.1	0.95	24.1	-	0.34	10	50
1/2"	4CM4B4-B-E	1/2"	brass	4.28	108.7	1.18	30.0	-	0.83	5	30
1/2"	4CM4B6-B-E	3/4"	brass	4.56	115.8	1.18	30.0	-	0.83	5	30

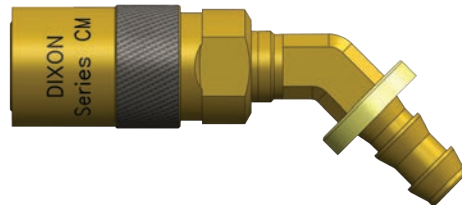
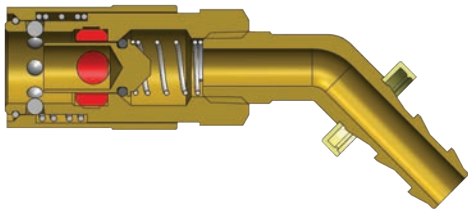

Body Size	CM-Series Industrial Mold Interchange Valved Coupler (45° Push-Loc Barb)										
	Part Detail			Length		Maximum OD		Hex Inch	Weight Lb	Package Qty	
	Part Number	Hose ID	Material	Inch	mm	Inch	mm			Bag	Box
1/4"	2CM4B2-B	1/4"	brass	2.86	72.6	0.69	17.5	-	0.14	10	100
1/4"	2CM4B3-B	3/8"	brass	2.92	74.2	0.69	17.5	-	0.17	10	100
3/8"	3CM4B3-B	3/8"	brass	3.82	97.0	0.95	24.1	-	0.36	10	50
3/8"	3CM4B4-B	1/2"	brass	3.98	101.1	0.95	24.1	-	0.40	10	50

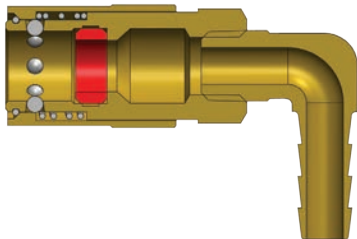

Body Size	CM-Series Industrial Mold Interchange Unvalved Coupler (90° Hose Barb)										
	Part Detail			Length		Maximum OD		Hex Inch	Weight Lb	Package Qty	
	Part Number	Hose ID	Material	Inch	mm	Inch	mm			Bag	Box
1/4"	2CM9S2-B-E	1/4"	brass	1.98	50.3	0.69	17.5	-	0.13	10	100
1/4"	2CM9S2.5-B-E	5/16"	brass	1.98	50.3	0.69	17.5	-	0.13	10	100
1/4"	2CM9S3-B-E	3/8"	brass	2.17	55.1	0.69	17.5	-	0.14	10	100
3/8"	3CM9S3-B-E	3/8"	brass	2.84	72.1	0.95	24.1	-	0.31	10	50
3/8"	3CM9S4-B-E	1/2"	brass	2.85	72.4	0.95	24.1	-	0.33	10	50
1/2"	4CM9S4-B-E	1/2"	brass	3.50	88.9	1.18	30.0	-	0.79	5	30
1/2"	4CM9S6-B-E	3/4"	brass	3.50	88.9	1.18	30.0	-	0.80	5	30

CM-Series Hydraulic Couplings

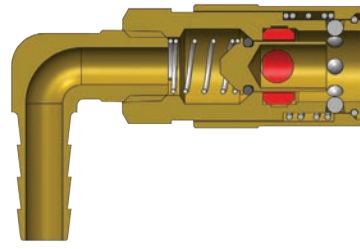

Body Size	CM-Series Industrial Mold Interchange Valved Coupler (90° Hose Barb)											
	Part Detail				Length		Maximum OD		Hex Inch	Weight Lb	Package Qty	
	Part Number	Hose ID	Material		Inch	mm	Inch	mm			Bag	Box
1/4"	2CM9S2-B	1/4"	brass		1.98	50.3	0.69	17.5	-	0.14	10	100
1/4"	2CM9S2.5-B	5/16"	brass		1.98	50.3	0.69	17.5	-	0.14	10	100
1/4"	2CM9S3-B	3/8"	brass		2.17	55.1	0.69	17.5	-	0.15	10	100
3/8"	3CM9S3-B	3/8"	brass		2.84	72.1	0.95	24.1	-	0.31	10	50
3/8"	3CM9S4-B	1/2"	brass		2.85	72.4	0.95	24.1	-	0.35	10	50

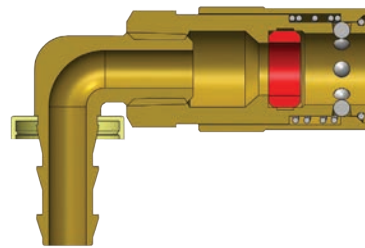
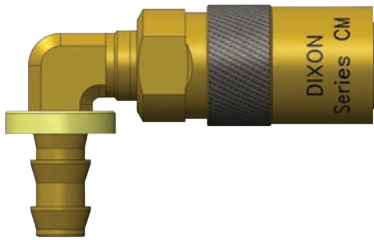

Body Size	CM-Series Industrial Mold Interchange Unvalved Coupler (90° Push-Loc Barb)											
	Part Detail				Length		Maximum OD		Hex Inch	Weight Lb	Package Qty	
	Part Number	Hose ID	Material		Inch	mm	Inch	mm			Bag	Box
1/4"	2CM9B2-B-E	1/4"	brass		2.07	52.6	0.69	17.5	-	0.14	10	100
1/4"	2CM9B3-B-E	3/8"	brass		2.17	55.1	0.69	17.5	-	0.16	10	100
3/8"	3CM9B3-B-E	3/8"	brass		2.93	74.4	0.95	24.1	-	0.37	10	50
3/8"	3CM9B4-B-E	1/2"	brass		2.98	75.7	0.95	24.1	-	0.37	10	50
1/2"	4CM9B4-B-E	1/2"	brass		3.50	88.9	1.18	30.0	-	0.83	5	30
1/2"	4CM9B6-B-E	3/4"	brass		3.50	88.9	1.18	30.0	-	0.83	5	30

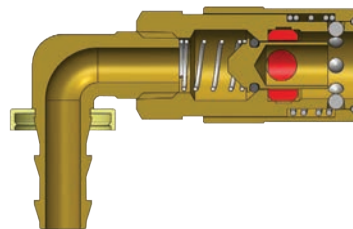
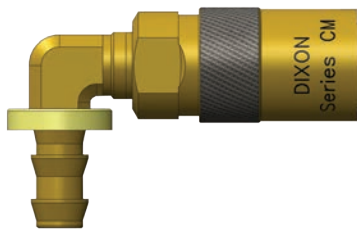

Body Size	CM-Series Industrial Mold Interchange Valved Coupler (90° Push-Loc Barb)											
	Part Detail				length		Maximum OD		Hex Inch	Weight Lb	Package Qty	
	Part Number	Hose ID	Material		Inch	mm	Inch	mm			Bag	Box
1/4"	2CM9B2-B	1/4"	brass		2.07	52.6	0.69	17.5	-	0.14	10	100
1/4"	2CM9B3-B	3/8"	brass		2.17	55.1	0.69	17.5	-	0.17	10	100
3/8"	3CM9B3-B	3/8"	brass		2.93	74.4	0.95	24.1	-	0.37	10	50
3/8"	3CM9B4-B	1/2"	brass		2.98	75.7	0.95	24.1	-	0.39	10	50

CM-Series Hydraulic Couplings

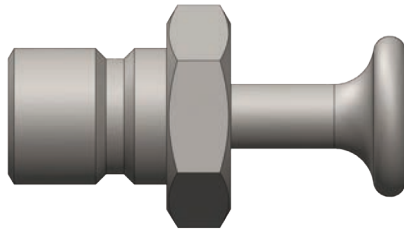

Body Size	CM-Series Coupler Rigid Dust Plug						
	Part Detail				Weight Lb	Package Qty	
	Part Number	Lanyard	Body			Bag	Box
1/4"	2CMPC-B	N/A	brass		0.09	10	100
3/8"	3CMPC-B	N/A	brass		0.12	10	50
1/2"	4CMPC-B	N/A	brass		0.15	5	30

Body Size	CM-Series Industrial Mold Interchange Coupler Seal Kits						
	Part Detail				Seal Kit Contents	Package Qty	
	Part Number	Coupler Style	Seal Material			Bag	Box
1/4"	2CM-SKIT	all	Silicone		Body Seal	25	200
3/8"	3CM-SKIT	all	Silicone		Body Seal	25	200
1/2"	4CM-SKIT	all	Silicone		Body Seal	25	200

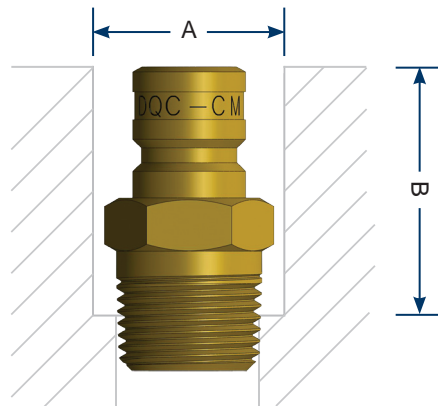

Counterbored mold ports will protect the male threaded nipple, allowing the nipple to be mounted below the surface, simplifying storing and handling of molds. Dixon male threaded plugs are constructed of corrosion resistant brass to maximize longevity in moist environments.

Body Size	Part Detail		Dimension A	Dimension B
	Part Number	Threads		
1/4"	CM2M1-B	1/8" - 27 NPTF	17.5 mm (0.69")	17.5 mm (0.69")
1/4"	CM2M2-B	1/4" - 18 NPTF	21.3 mm (0.84")	23.9 mm (0.94")
1/4"	CM2M3-B	3/8" - 18 NPTF	25.4 mm (1.00")	24.6 mm (0.97")
3/8"	CM3M2-B	1/4" - 18 NPTF	17.5 mm (0.69")	23.9 mm (0.94")
3/8"	CM3M3-B	3/8" - 18 NPTF	21.3 mm (0.84")	28.7 mm (1.13")
3/8"	CM3M4-B	1/2" - 14 NPTF	25.4 mm (1.00")	31.8 mm (1.25")
1/2"	CM4M4-B	1/2" - 14 NPTF	31.8 mm (1.25")	38.1 mm (1.50")
1/2"	CM4M6-B	3/4" - 14 NPTF	38.1 mm (1.50")	39.6 mm (1.56")