

# A-Series Pneumatic Couplings

## Interchange Data:

- Dixon Quick Coupling Proprietary Astronautics

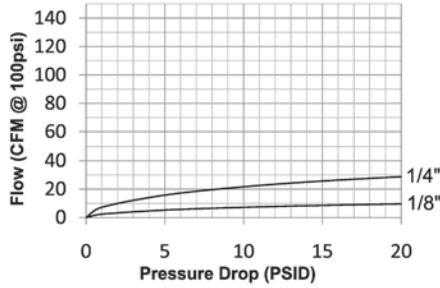

## Materials:

- Machined components are manufactured using solid steel or brass bar stock.
- Stainless steel balls, retaining rings, and springs maximize corrosion resistance and extend service life.
- Steel componentry is plated using ROHS Compliant Trivalent Chrome.
- Couplers are constructed of brass with steel valve as standard.

## Seal Components:

- Nitrile (Buna-N) seals are standard, providing a temperature range of -40°F to +250°F (-40°C to +121°C).

## Rated Pressure Chart:

Body Size	A-Series Astronautics High Pressure Pneumatic (Connected)							
	Brass Coupler/Steel Plug				Brass Coupler/Plug			
	Maximum Working		Burst		Maximum Working		Burst	
	PSI	Bar	PSI	Bar	PSI	Bar	PSI	Bar
1/8"	1,000	70	18,500	1,275	500	35	15,500	1,070
1/4"	1,000	70	8,000	550	500	35	6,500	450

## Technical Specifications:

Body Size	Interchange Standards				Functional Parameters				
	U.S. Military	U.S. Government	International Standards	ANSI/NFPA Standards	Locking Ball Quantity	Air Inclusion	Fluid Loss	Vacuum Rating	Flow ΔP = 15 PSI
1/8"	-	-	-	-	3	N/A	N/A	N/R	8.6 CFM
1/4"	-	-	-	-	3	N/A	N/A	N/R	26 CFM

## List Price Seal Option Adders:

Body Size	Seal Options				Valve Options						Sleeve Options				Treatments	
	Viton®		EPDM		Unvalved		Brass		303SS		Flanged		Sleeve-Lock		Oxy-Clean	
	Pre	Add \$	Pre	Add \$	Suf	Add \$	Suf	Add \$	Suf	Add \$	Suf	Add \$	Suf	Add \$	Suf	Add \$
1/8"	F-		P-		-E		-BV		-SV		-FS	N/A	-LS		-C1	
1/4"	F-	N/A	P-	N/A	-E	-3.80	-BV	N/A	-SV	N/A	-FS	N/A	-LS	8.90	-C1	

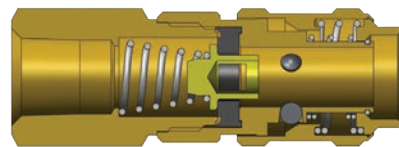
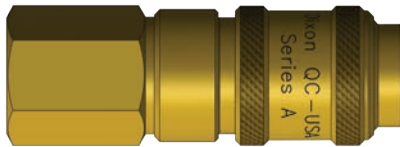

Body Size	A-Series Astronautics High Pressure Pneumatic Coupler (Female Threads)											
	Part Number	Threads	Material		Inch	mm	Inch	mm	Hex Inch	Weight Lb	Package Qty	
											Bag	Box
1/8"	1AF1-B	1/8" - 27 NPTF	brass		1.68	42.7	0.64	16.3	1/2"	0.08	10	100
1/4"	2AF1-B	1/8" - 27 NPTF	brass		2.41	61.2	0.77	19.6	1/2"	0.17	10	100
1/4"	2AF2-B	1/4" - 18 NPTF	brass		2.70	68.6	0.77	19.6	11/16"	0.16	10	100

## A-Series Pneumatic Couplings

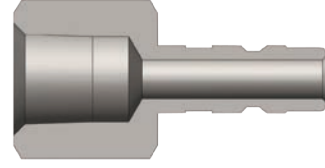
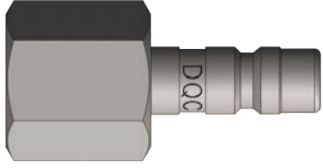

Body Size	A-Series Astronautics High Pressure Pneumatic Nipple (Female Threads)											
	Part Detail			Length		Maximum OD		Hex Inch	Weight Lb	Package Qty		
	Part Number	Threads	Material	Inch	mm	Inch	mm			Bag	Box	
1/8"	A1F1-B	1/8" - 27 NPTF	brass	1.26	32.0	0.58	14.7	1/2"	0.03	10	100	
1/4"	A2F1-B	1/8" - 27 NPTF	brass	1.34	34.0	0.65	16.5	9/16"	0.08	10	100	
1/4"	A2F2	1/4" - 18 NPTF	steel	1.56	39.6	0.79	20.1	11/16"	0.07	10	100	
1/4"	A2F2-B	1/4" - 18 NPTF	brass	1.56	39.6	0.79	20.1	11/16"	0.07	10	100	

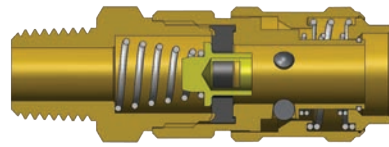

Body Size	A-Series Astronautics High Pressure Pneumatic Coupler (Male Threads)											
	Part Detail			Length		Maximum OD		Hex Inch	Weight Lb	Package Qty		
	Part Number	Threads	Material	Inch	mm	Inch	mm			Bag	Box	
1/8"	1AM1-B	1/8" - 27 NPTF	brass	1.75	44.5	0.64	16.3	1/2"	0.08	10	100	
1/4"	2AM1-B	1/8" - 27 NPTF	brass	2.12	53.8	0.77	19.6	11/16"	0.17	10	100	
1/4"	2AM2-B	1/4" - 18 NPTF	brass	2.23	56.6	0.77	19.6	11/16"	0.16	10	100	

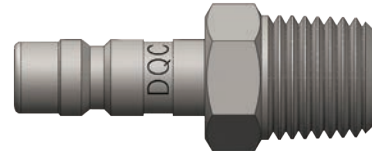
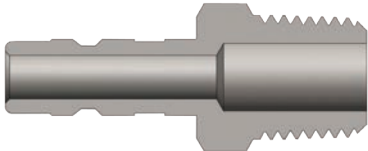

Body Size	A-Series Astronautics High Pressure Pneumatic Nipple (Male Threads)											
	Part Detail			Length		Maximum OD		Hex Inch	Weight Lb	Package Qty		
	Part Number	Threads	Material	Inch	mm	Inch	mm			Bag	Box	
1/8"	A1M1-B	1/8" - 27 NPTF	brass	1.30	33.0	0.51	13.0	7/16"	0.02	10	100	
1/4"	A2M2	1/4" - 18 NPTF	steel	1.59	40.4	0.65	16.5	9/16"	0.03	10	100	
1/4"	A2M2-B	1/4" - 18 NPTF	brass	1.59	40.4	0.65	16.5	9/16"	0.03	10	100	

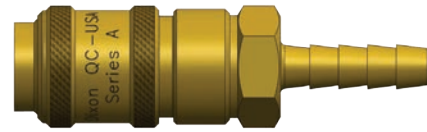
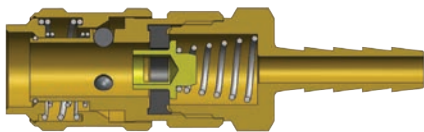

Body Size	A-Series Astronautics High Pressure Pneumatic Coupler (Hose Barb)											
	Part Detail			Length		Maximum OD		Hex Inch	Weight Lb	Package Qty		
	Part Number	Hose ID	Material	Inch	mm	Inch	mm			Bag	Box	
1/8"	1AS1-B	1/8"	brass	1.98	50.3	0.64	16.3	1/2"	0.07	10	100	
1/4"	2AS2-B	1/4"	brass	2.70	68.6	0.77	19.6	11/16"	0.15	10	100	

## A-Series Pneumatic Couplings

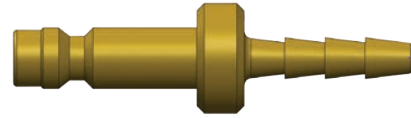
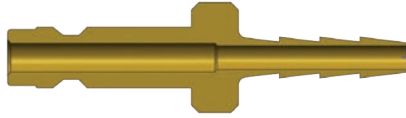

Body Size	A-Series Astronautics High Pressure Pneumatic Nipple (Hose Barb)											
	Part Detail				Length		Maximum OD		Hex Inch	Weight Lb	Package Qty	
	Part Number	Hose ID	Material		Inch	mm	Inch	mm			Bag	Box
1/8"	A1S1-B	1/8"	brass		1.50	38.1	0.44	11.2	-	0.02	10	100
1/4"	A2S2	1/4"	steel		1.99	50.5	1.01	25.7	-	0.04	10	100

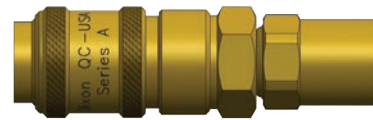
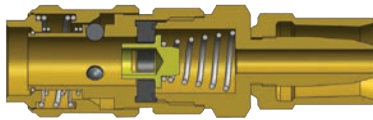

Body Size	A-Series Astronautics High Pressure Coupler (Reusable Barb)											
	Part Detail				Length		Maximum OD		Hex Inch	Weight Lb	Package Qty	
	Part Number	Hose ID x OD	Material		Inch	mm	Inch	mm			Bag	Box
1/4"	2AE2-B	1/4" x 1/2"	brass		2.62	66.5	0.77	19.6	11/16"	0.17	10	100
---	---	---	---	---	--	--	--	--	--	--	--	--

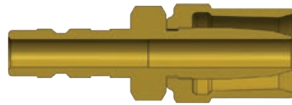

Body Size	A-Series Astronautics High Pressure Nipple (Reusable Barb)											
	Part Detail				Length		Maximum OD		Hex Inch	Weight Lb	Package Qty	
	Part Number	Hose ID x OD	Material		Inch	mm	Inch	mm			Bag	Box
1/4"	A2E2	1/4" x 1/2"	steel		1.97	50.0	0.68	17.3	9/16"	0.08	10	100
1/4"	A2E2-B	1/4" x 1/2"	brass		1.97	50.0	0.68	17.3	9/16"	0.08	10	100

### A Series Profile

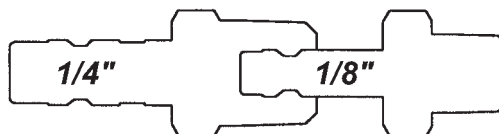

Operating pressure for couplings utilizing hose barb end connections may be dramatically reduced to that of the hose rating and/or hose end connection combination. Consult hose manufacturer's catalog for hose end connection ratings. If in doubt, test under controlled conditions for suitability to application. Dixon Quick Coupling cannot assume liability for misapplication of production resulting in equipment down-time, lost production, and/or personal injury including death.

